

ISOMETRIC VIEW FOR
REFERENCE ONLY

ITEM NO	QTY	PART NO	DESCRIPTION
1	1	100-113	PAN TILT MNT ARM
2	2	100-123	TOP BRKT FOR SPRT ARM
3	1	100-124	SUPPORT ARM
4	4	5950-1235	1/4" FL WASHER, SAE, STL, PL
5	2	5950-1325	1/4" LK WASHER, STL, PL
6	2	6000-1135	1/4-20, HX NUT, GR5, PL
7	2		1/4-20 X 1-1/4 HEX HEAD
8	2	5900-2345	1/4-20 X 1/2" SELF THREADING SCREW
9	2	100-120	BOT BRKT FOR SPRT ARM



DISPLAY DEVICES, INC
5880 SHERIDAN BLVD
ARVADA, CO 80003

THE INFORMATION CONTAINED HEREIN IS THE PROPERTY OF DISPLAY DEVICES, INC. ANY REPRODUCTION OR TRANSMISSION OF THIS INFORMATION WITHOUT THE WRITTEN PERMISSION OF DISPLAY DEVICES, INC IS PROHIBITED

TOLERANCES:
.XX = ± .02
.XXX = ± .010
.XXXX = ± .0050
ANGLE = ± 0.5

DRAWN	BAR	DATE	4/3/2001
CHECKED		DATE	
MATERIAL			
FINISH			

NONE	NONE
NONE	NONE

SIZE	DRAWING NO.	REV
B	100-125	-
SCALE	FILE NAME	SHEET 1 OF 2
NONE	100-125.SLDDRW	

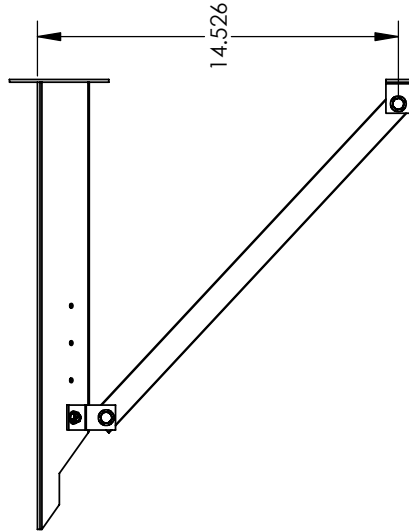
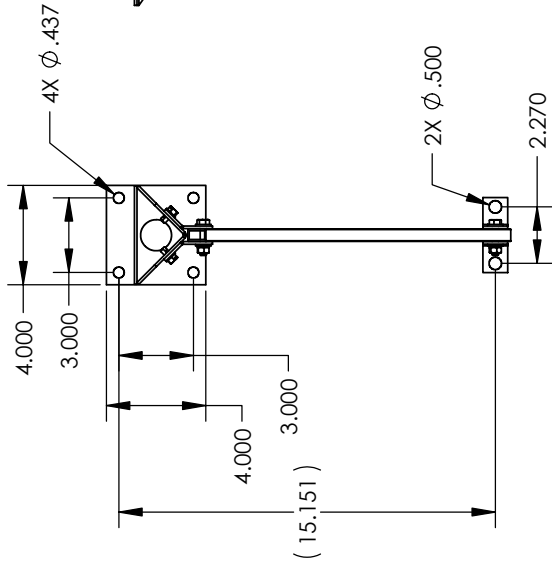
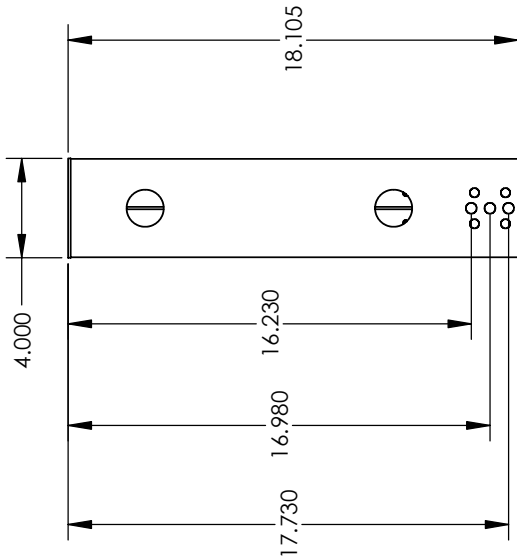

THE INFORMATION CONTAINED
HEREIN IS THE PROPERTY OF DISPLAY
DEVICES, INC. ANY
REPRODUCTION OR
TRANSMISSION IN ANY
FORM OR BY ANY MEANS
WITHOUT THE WRITTEN PERMISSION OF
DISPLAY DEVICES, INC. IS
PROHIBITED.

TOLERANCES:
.XX = ± .02
.XXX = ± .010
.XXXX = ± .0050
ANGLE = ± 0.5

DISPLAY DEVICES, INC
5880 SHERIDAN BLVD
ARVADA, CO 80003

MNT ARM W/SUPPORT

DATE	SIZE	DRAWING NO.	REV
4/3/2001	B	100-125	-
DRAWN	CHECKED	MATERIAL	FINISH
BAR			
DATE	SCALE	FILE NAME	SHEET
NONE	NONE	100-125.SLDDRW	2 OF 2